

**KEY**

- ① Aluminium colonnade system - 76dia ATDC CR2 columns with base cover. ATDC CR6 615x205 circle frieze panel (3no per bay) in extruded 'H' section frame. All in powder coat finish. Colour RAL6005 green. All to specialist fabricators own details (Andy Thornton or equal and approved)
- ② Formed stainless steel sheet corner cover panels
- ③ Enlarged clock access hatch
- ④ Main field back panels in laser engraved stainless steel, black finish on matt stainless steel. Text/artwork TBC. (see cut-tech.co.uk or equal and approved)
- ⑤ Existing bench seat over-clad in polished finish stainless steel sheet
- ⑥ Bench framing and back panels to have anti-vandal paint finish. Colour RAL6005 green
- ⑦ New glass fibre reinforced polyester roof with lead roll effect. Double layer jointless system. Polyroof 185 or equal and approved. Colour mid grey
- ⑧ Existing ornate brackets refurbished and finished to match colonnade
- ⑨ Existing ornate cast iron clock tower face panel fully restored. Main panel colour: BS10B15, niche colour BS16E53
- ⑩ Gold leaf finish to decorate details
- ⑪ Prepare existing concrete perimeter floor as required and apply a new 18mm deep resin bound 6mm aggregate finish on a crack reduction membrane grid system sheet (Sure Set 'Barley Beach' or equal and approved)
- ⑫ Existing ornate cast iron domes to clock tower fully restored. Colour to match colonnade roof
- ⑬ 125x100x3mm traditional ogee section extruded aluminium gutter with bespoke corner joint sections and 4No. spout outlets. Finish: powder coated, colour to match colonnade
- ⑭ 20mm Polyrey HPL bonded board (Ref: M017 Face, Black edges) fixed on suspended timber frame with black shadow gap joints or equal and approved

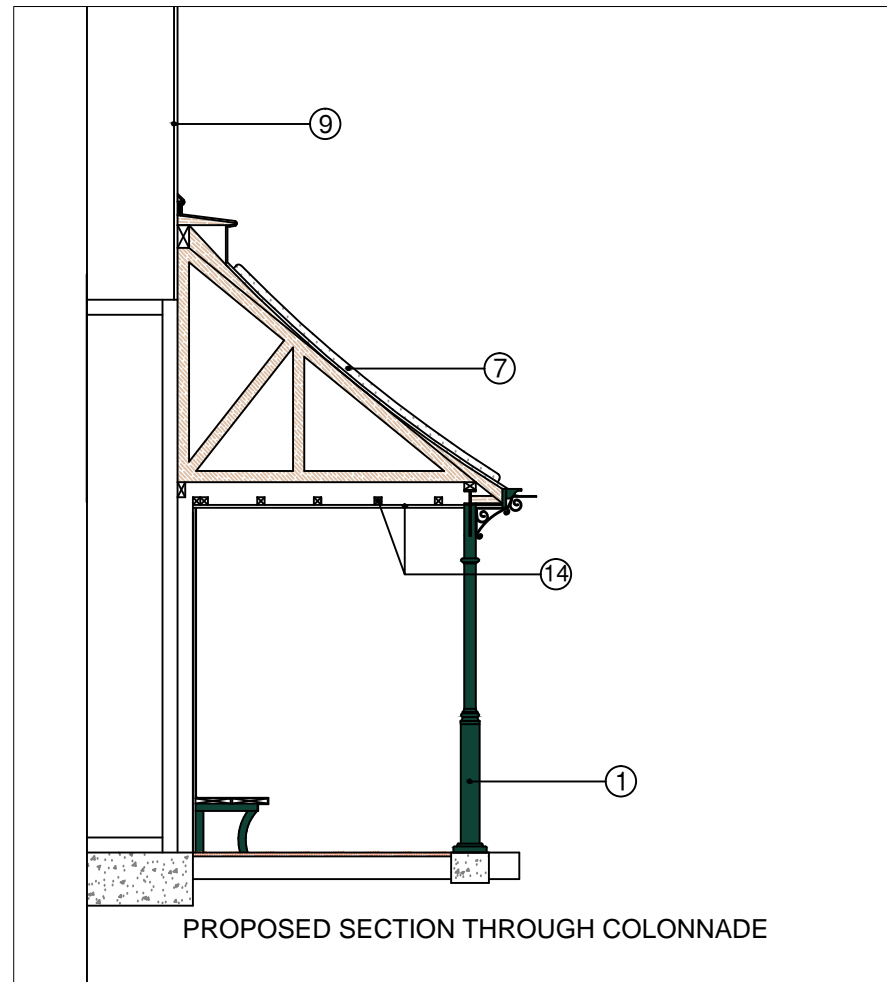

PROPOSED SECTION THROUGH COLONNADE

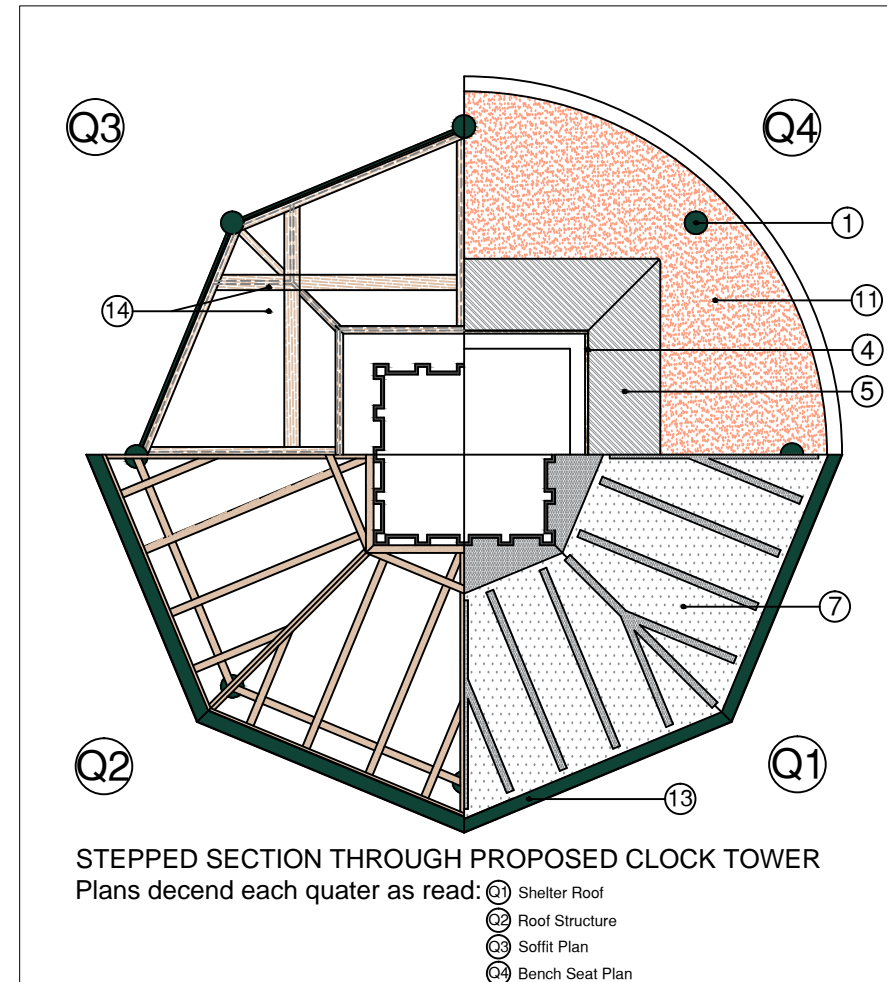

STEPPED SECTION THROUGH PROPOSED CLOCK TOWER

- Plans descend each quarter as read:
- ① Shelter Roof
  - ② Roof Structure
  - ③ Soffit Plan
  - ④ Bench Seat Plan

KEY PLAN



NOTES:

This drawing is produced for use in this project only and may not be used for any other purpose. NPS Property Consultants Ltd accept no liability for the use of this drawing other than the purpose for which it was intended in connection with this project as recorded on the title block fields 'Purpose for Issue' and 'File Status Code'.

This drawing may not be reproduced in any form without prior written agreement.

Do not scale from the drawing, use written dimensions only.

CHECKED BY:	DATE:
REVISED BY:	DATE:

SCALE BAR

PURPOSE OF ISSUE

FILE STATUS CODE

© COPYRIGHT NPS GROUP  
Crown Copyright & Database Rights [2014] Ordnance Survey [100019567] A3



**NPS Leeds LTD**  
 EVOLUTION HOUSE  
 SPRINGWELL ROAD, LEEDS  
 WEST YORKSHIRE, LS12 1AW  
 TEL: 0113 3201630 FAX: 0113 3201631  
 EMAIL: leeds@nps.co.uk

Head Office:  
 Lancaster House, 16 Central Avenue, St Andrews Business Park,  
 Norwich, NR7 0HR Tel: 01603 706000 Fax: 01603 706001

Other Office locations can be found on our website: www.nps.co.uk

CLIENT  
**OTRA/LEEDS CITY COUNCIL**

PROJECT  
**OAKWOOD CLOCK RESTORATION**

TITLE  
**PROPOSED ELEVATIONS AND SECTIONS**

SCALES	DATE	DRAWN	CHECKED
1:100/1:50	06/06/2014	DAE	DAE

FILE / DRAWING NAME	REV CODE
PROJECT NR	DRAWING FIELDS
15-1-2014	NPS-DR-B
UNIQUE NR	005